

Bare Base Metal Thermocouple Wire

CODE	TYPE / POL.	MATERIAL	GA.	FT. / LB.
JP08B	J (+)	Iron	8	23
JN08B	J (-)	Constantan	8	20
JP14B	J (+)	Iron	14	91
JN14B	J (-)	Constantan	14	80
JP20B	J (+)	Iron	20	365
JN20B	J (-)	Constantan	20	323
KP08B	K (+)	Chromel	8	21
KN08B	K (-)	Alumel	8	21
KP14B	K (+)	Chromel	14	83
KN14B	K (-)	Alumel	14	83
KP20B	K (+)	Chromel	20	313
KN20B	K (-)	Alumel	20	313

Bare Noble Metal Thermocouple Wire

CODE	TYPE / POL.	MATERIAL	GA.	IN. / TROY OZ.
RP24B	R (+)	Plat. 13% Rh	24	309
SP24B	S (+)	Plat. 10% Rh	24	302
PN24B	R S (-)	Pure Platinum	24	282
RP26B	R (+)	Plat. 13% Rh	26	482
SP26B	S (+)	Plat. 10% Rh	26	473
PN26B	R S (-)	Pure Platinum	26	440

NOTES: All wire supplied bright annealed. Wire orders must be for equal amounts of both legs. All listed wire is supplied as standard limits of error.

Thermocouple Alloy Terminal and Spade Lugs

TERMINAL LUG CODE ^[1]	SPADE LUG CODE ^[2]	ANSI LETTER DESIGNATION	THERMOCOUPLE ALLOY
460053	460060	KP, EP	Chromel
460052	460059	KN	Alumel
460056	460063	JP	Iron
460054	460061	JN, EN, TN	Constantan
460055	460062	TP, RP, SP	Copper
460051	460116	RN, SN	Alloy #11

[1] Terminal lugs fit Cinch Jones Series #141 and equivalent Barrier terminal blocks with 27/64" screw spacing and #6-32 terminal screws.

[2] Spade lugs are crimp-on style to fit #6-32 terminal screws and 18 awg. wire or smaller.

INSULATOR DIMENSIONS

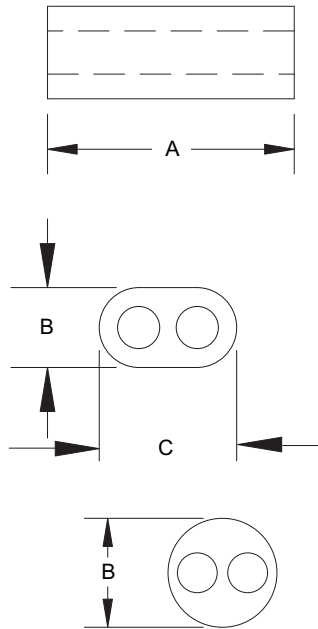

Cordierite Insulators (2250 °F max)

CODE	STYLE	GA.	A DIM. (inches)	B DIM. (inches)	C DIM. (inches)	NO BORE(S)
408-1C	Oval	8	1	0.281	0.500	2
408-1R	Round	8	1	0.465		2
408-3C	Oval	8	3	0.281	0.500	2
408-3R	Round	8	3	0.465		2
408-B	Fish spine	8	1/4	0.26		1
408-12S ^[1]	Fish spine	8	12	0.260		1
411-1C	Oval	11	1	0.218	0.375	2
411-3C	Oval	11	3	0.218	0.375	2
414-1C	Oval	14	1	0.188	0.313	2
414-1R	Round	14	1	0.250		2
414-3C	Oval	14	3	0.188	0.313	2
414-B	Fish spine	14	1/4	0.200		1
414-12S ^[1]	Fish spine	14	12	0.200		1
420-1C	Oval	20	1	0.188	0.172	2
420-12S ^[1]	Fish spine	20	12	0.125		1

Alumina Insulators (3400 °F max)

CODE	STYLE	GA.	A DIM. (inches)	B DIM. (inches)	C DIM. (inches)	NO BORE(S)
424-12	Round	24	12	0.188		4
424-18	Round	24	18	0.188		4
424-24	Round	24	24	0.188		4
424-30	Round	24	30	0.188		4

[1] 12S fish spine insulators supplied in continuous 12" sleeves.

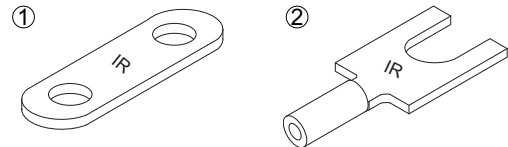

COMPLETE COMPENSATED TERMINAL BLOCKS

EXAMPLE ORDER NUMBER: **26 - 240 - 08**

Terminal Block Thermocouple Type

PREFIX CODE	T/C TYPE	THERMOCOUPLE ALLOY	
		POSITIVE	NEGATIVE
26 - 220	E	Chromel	Constantan
26 - 230	J	Iron	Constantan
26 - 240	K	Chromel	Alumel
26 - 250	R-S	Copper	Alloy #11
26 - 260	T	Copper	Constantan
26 - 270	U	Copper	Copper

Consult factory for combination blocks.

Number of Circuits

SUFFIX CODE	CIRCUITS (TERMINALS)	L DIMENSION (inches)
02	2 (4)	2 1/2
04	4 (8)	4 1/2
05	5 (10)	5 3/8
06	6 (12)	6
08	8 (16)	7 3/4
10	10 (20)	9 1/2

Consult factory for other number of circuits.

